

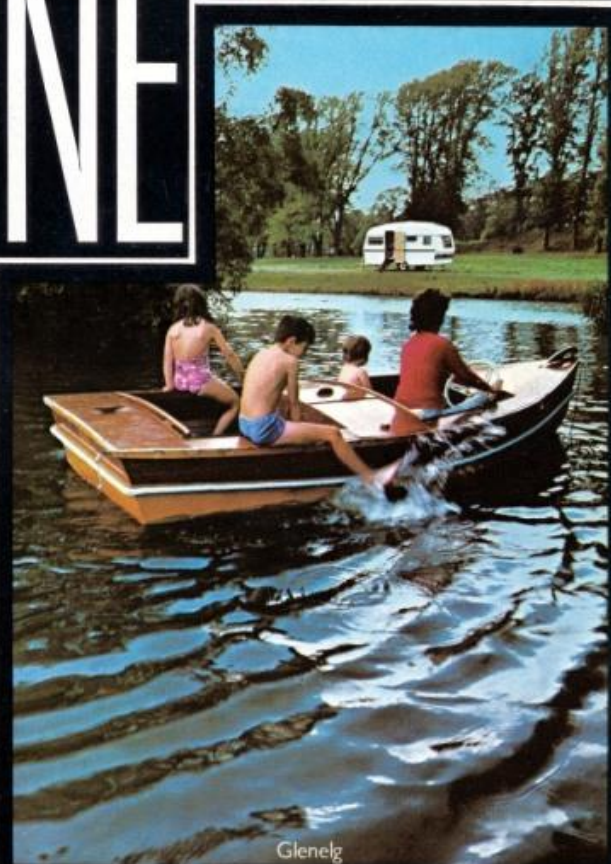

Thomson T-LINE

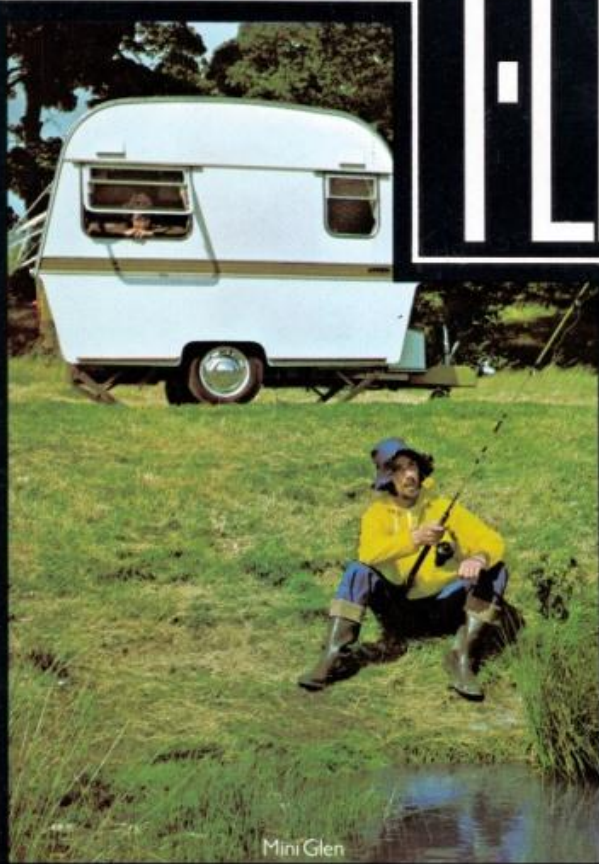

T h o m s o n T - L i n e C a r a v a n s



Glennevis

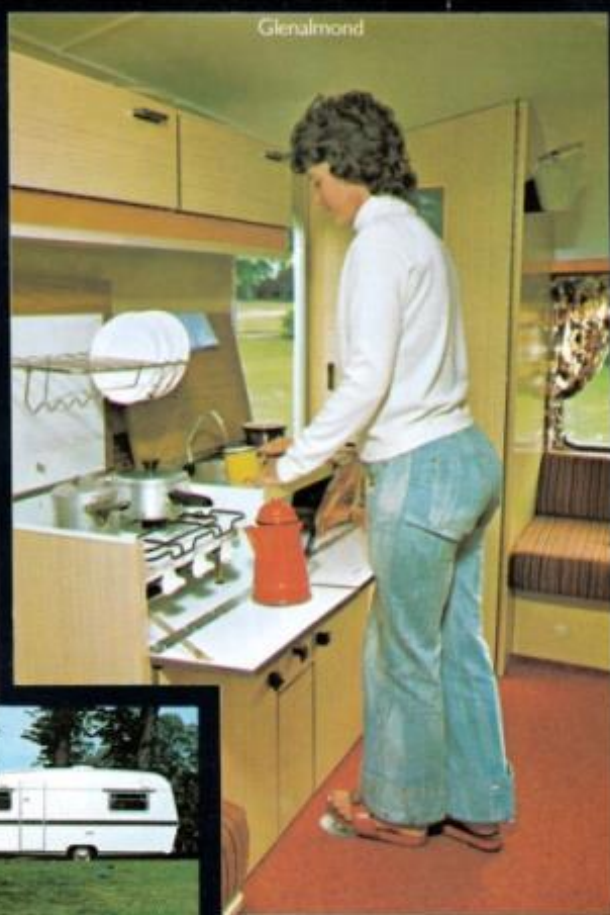

Glenalmond



Glenalmond

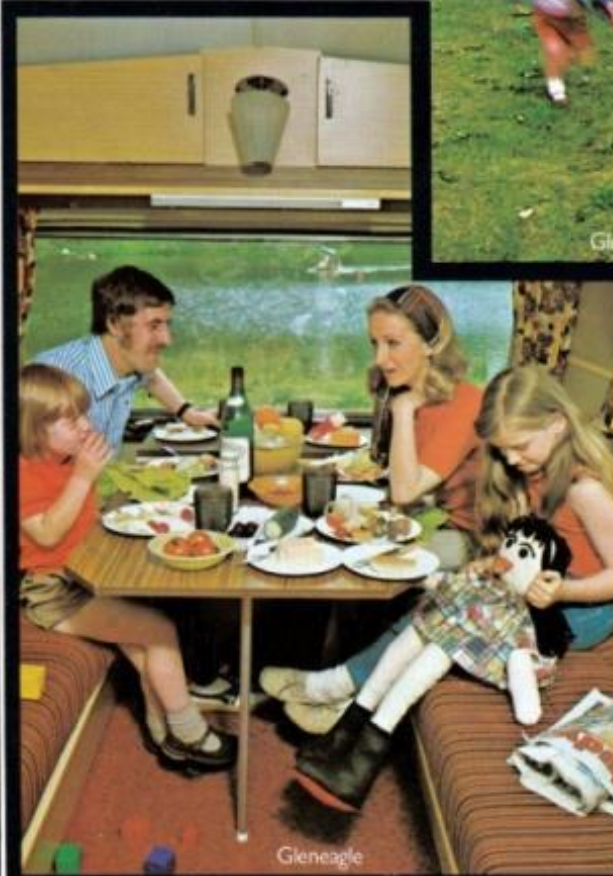

Gleneagle

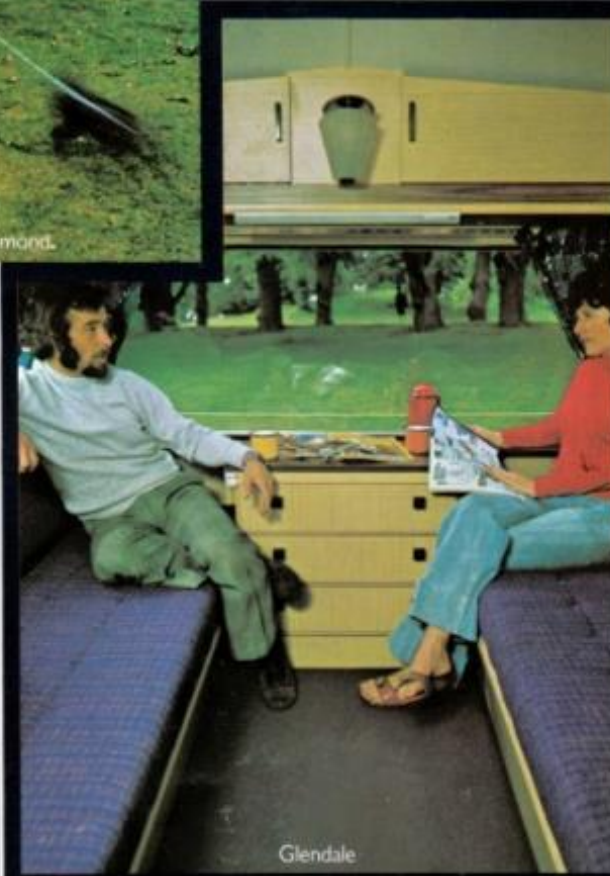

Glendale

We've often been asked what the T in T-Line stands for. Well, certainly, it stands for Thomson. But then that's our little concession to vanity, which is understandable, after nearly 70 years in the business of building caravans.

We like to think, however, that the T represents a great many qualities that you'll find in our caravans. For instance:

T means Thoroughbred: We and our staff of craftsmen have been hand-building caravans in Scotland for a great many years now. Our caravans are made for caravan enthusiasts by caravan enthusiasts.

T means Tough: We make caravans tough enough to stand up to years of effortless towing. In an age of mass production we still build our caravans by hand to stand the strain of countless journeys.

T means Trim: We have spent a lot of time designing so that you get the best out of space and fitting refinements. You'll find we've used every inch to produce real labour saving interiors.

T means Tasteful: We have given the T-Line caravans style with dashing lines. Outside, the heavy duty aluminium body panels are finished in glossy acrylic enamel. Inside, stainless steel sink units and draining boards, easy wipe surfaces in teak pattern, and hard-wearing quilted upholstery

and pile carpets give an air of real luxury.

T means Trustworthy: We build all our models to meet the British Standard specifications for touring trailers. And whatever the model, the safety is the same throughout the complete range, with rigid steel chassis, planned weight distribution, superb brakes, independent suspension, and hydraulic damper couplings on every caravan, to take the strain out of towing and out of you.

T means Thrifty: Whether you are thinking of buying a small caravan just right for the 1000cc car or the luxury Gleneagle, you'll find there is a Thomson caravan at a price to suit your pocket.

T means Twelve: For 1975 we've twelve models for you to choose from, ranging from the baby Mini-Glen to the spacious Gleneagle and the new

luxury Glenbervie.

T means Travel: T-Line will take you anywhere and back in safety and comfort. Travel the world by T-Line - many of our customers do.

Our supply of words beginning with T is far from being exhausted. We feel extremely confident however, that T times eight describes very effectively most of the qualities you will find in our range of caravans. Care to come along and tow away a T-Line?

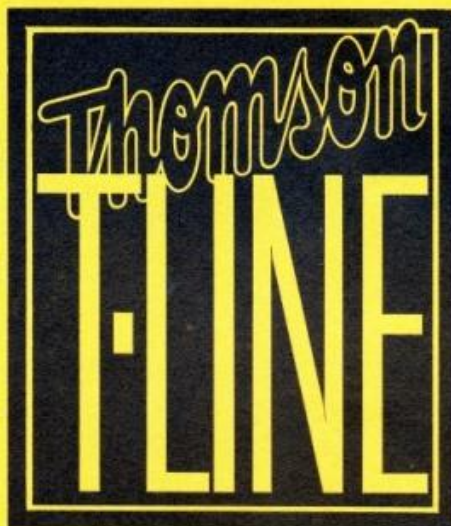

MINI GLEN

2 berth. Pure Thomson ingenuity. We've packed a dining area that converts into a double-bed, a kitchenette complete with hot plate, grill and sink unit/drainage, a full size wardrobe and toilet all into a caravan only 9 ft. 5 ins. long.

GLEN 2

2 berth. A small caravan with big comforts. With twin beds that can be converted into a double, adjustable back rests, panoramic rear window and custom-built chest of drawers/dining table mounting.

GLENDALE

2 berth. A luxurious caravan for two. This spacious 12 foot T-Line gives you polished plywood decor, fitted carpet, rich textured upholstery and room to entertain your friends.

GLEN 4

4 berth. The Glen 4 combines two separate living/sleeping areas divided by a fully fitted kitchen, wardrobe and partition curtain. Pound for pound an outright winner in the budget class.

A Griller/Hotplate
B Sink
C Toilet
E Dinette Bed 73" x 46"
I Wardrobe
J Roof Locker
K Roof Locker and Shelf
M Table Position
N Cabinet

A Griller/Hotplate
B Sink
C Toilet
D Single Bed each 72" x 24"
I Wardrobe
J Roof Locker
K Roof Locker and Shelf
M Table Position
O Chest of Drawers

A Griller/Hotplate
B Sink
C Toilet
D Single Bed each 75" x 24"
I Wardrobe
J Roof Locker
K Roof Locker and Shelf
M Table Position
N Cabinet for Refrigerator
O Chest of Drawers

A Griller/Hotplate
B Sink
E Dinette Bed 73" x 46"
F Single Bed 72" x 24"
H Hammock Above 69" x 22"
I Wardrobe
J Roof Locker
K Roof Locker and Shelf
M Table Position
P Shelf

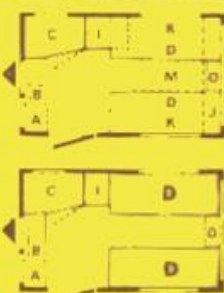

GLENNEVIS

4-5 berth. We go out of our way with our caravans to keep everything out of yours. The Glennevis has a sparkling stainless steel sink unit, luxurious upholstery, teak pattern working surfaces, loads of storage space and toilet compartment and room for an optional fifth berth.

GLENNEVIS J

For many years a winner of export sales the "J" type layout is introduced for 1975 whilst maintaining the compactness of the standard Glennevis.

The new model offers the convenience of two double dinettes and the luxury of two tables.

GLENELG

4-5 berth. Our best seller. Partly because of the interior planning. Wipe clean vinyl-coated roof panels, modern work units, and roomy end roof lockers are just some of the features that make the Glenelg outstanding value. And the family favourite – even for five at your option.

GLENELG J

Children will love the layout of the Glenelg "J" which gives them their own table for dining and playing whilst leaving Mum and Dad to enjoy the spaciousness of the forward dinette and its separate table.

A Griller/Hotplate
B Sink
C Toilet
E Dinette Bed 73"x 46"
F Single Bed 72"x 24"
Bunk Above 69"x 22"
I Wardrobe
J Roof Locker
K Roof Locker and Shelf
M Table Position
P Shelf

A Griller/Hotplate
B Sink
C Toilet
E Dinette Bed 73"x 46"
I Wardrobe
J Roof Locker
K Roof Locker and Shelf
M Table Position
P Shelf

A Griller/Hotplate
B Sink
C Toilet
E Dinette Bed 73"x 46"
F Single Bed 72"x 24"
Bunk Above 69"x 22"
I Wardrobe
J Roof Locker
K Roof Locker and Shelf
M Table Position

A Griller/Hotplate
B Sink
C Toilet
E Dinette Bed 73"x 46"
I Wardrobe
J Roof Locker
K Roof Locker and Shelf
M Table Position

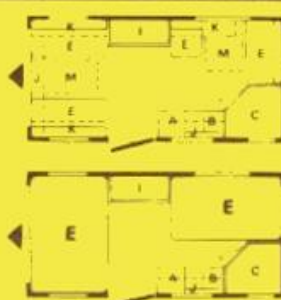
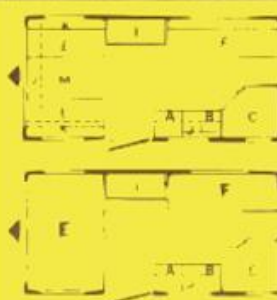
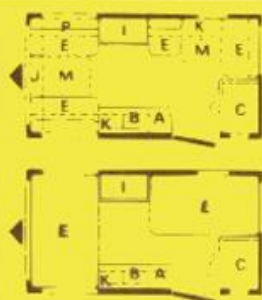
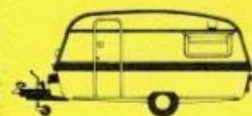
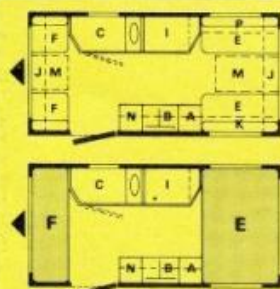

Diagram and detailed specifications of each caravan not to scale

GLENBERVIE

Even the most discriminating housewife will relish the space and grace provided in the Glenbervie kitchen. An entirely new model from T-Line providing sleeping accommodation for three or four with a toilet compartment of giant proportions; fitted with vanity cabinet and personal wash facility.

- A Griller/Hotplate
- B Sink
- C Toilet with Vanity Unit
- E Dinette Bed 73" x 46"
- F Single Bed 72" x 24"
- Bunk Above 69" x 22"
- I Wardrobe with shelves
- J Roof Locker
- K Roof Locker and shelf
- M Table Position
- N Cabinet for Refrigerator
- P Shelf



GLENALMOND

4-6 berth. It'll sleep 4, 5 or even 6 in all the comfort you care to dream about. That big, big window in the rear end dinette gives caravanners a tremendous outlook for 1975. And the optional fifth and sixth berths take up little of the spaciousness.

- A Griller/Hotplate
- B Sink
- C Toilet
- D Single Bed each 72" x 24"
- E Dinette Bed 73" x 46"
- I Wardrobe
- J Roof Locker
- K Roof Locker and Shelf
- M Table Position
- O Chest of Drawers

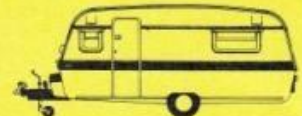
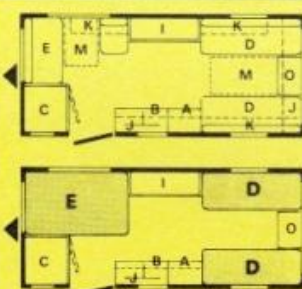

GLENMORE

4-5 berth. 2 large doors give the 4 occupants real freedom to move around, with ample space to spare for an optional fifth. Wardrobe and kitchen space is on the grand scale. The two-door feature makes the Glenmore an ideal choice for holidays at home or abroad.

- A Griller/Hotplate
- B Sink
- C Toilet
- E Dinette Bed 73" x 46"
- F Single Bed 72" x 24"
- Bunk Above 69" x 22"
- I Wardrobe
- J Roof Locker
- K Roof Locker and Shelf
- M Table Position
- N Cabinet for Refrigerator

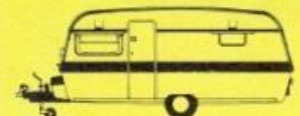
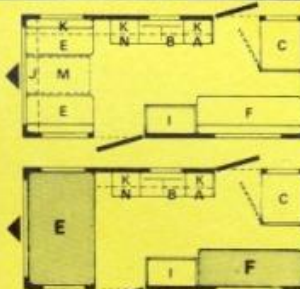

GLENEAGLE

4-6 berth. The ultimate in highway holiday comfort. Thomsons took 17 ft of caravan and carried fitting refinements just as far as they could go. 2 single beds and a full size double-bed come as standard and in addition two Pullman bunks can be supplied. Full oven cooker is part of the standard specification.

- A Full Oven Cooker
- B Sink
- C Toilet
- D Single Bed each 72" x 24"
- G Settee Bed 72" x 46"
- I Wardrobe
- J Roof Locker
- K Roof Locker and Shelf
- L Sideboard
- M Table Position
- N Cabinet for Refrigerator
- O Chest of Drawers
- P Shelf

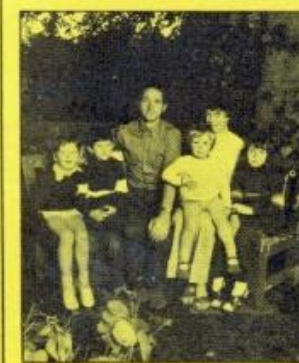
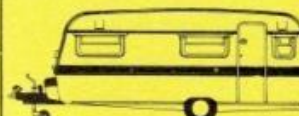
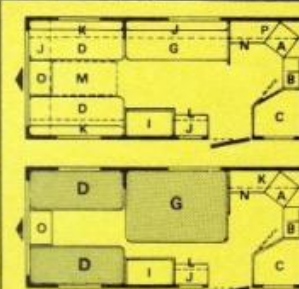

The sink unit.
The stainless steel sink unit and draining board make your caravan as functional as your own kitchen.



Fluorescent lighting.

In addition to gas lighting Thomson Caravans are fitted with fluorescent strip lighting. Just plug in to your car socket and switch on.



Tow-pole fairing and gas cylinder chest.

In keeping with the design of the rest of the caravan the tow-pole is covered to protect it from slinging mud. And a compact chest also keeps the gas cylinders neatly and safely out of harm's way. Note the embossed metal stone-guard to protect against flying chips and stones.

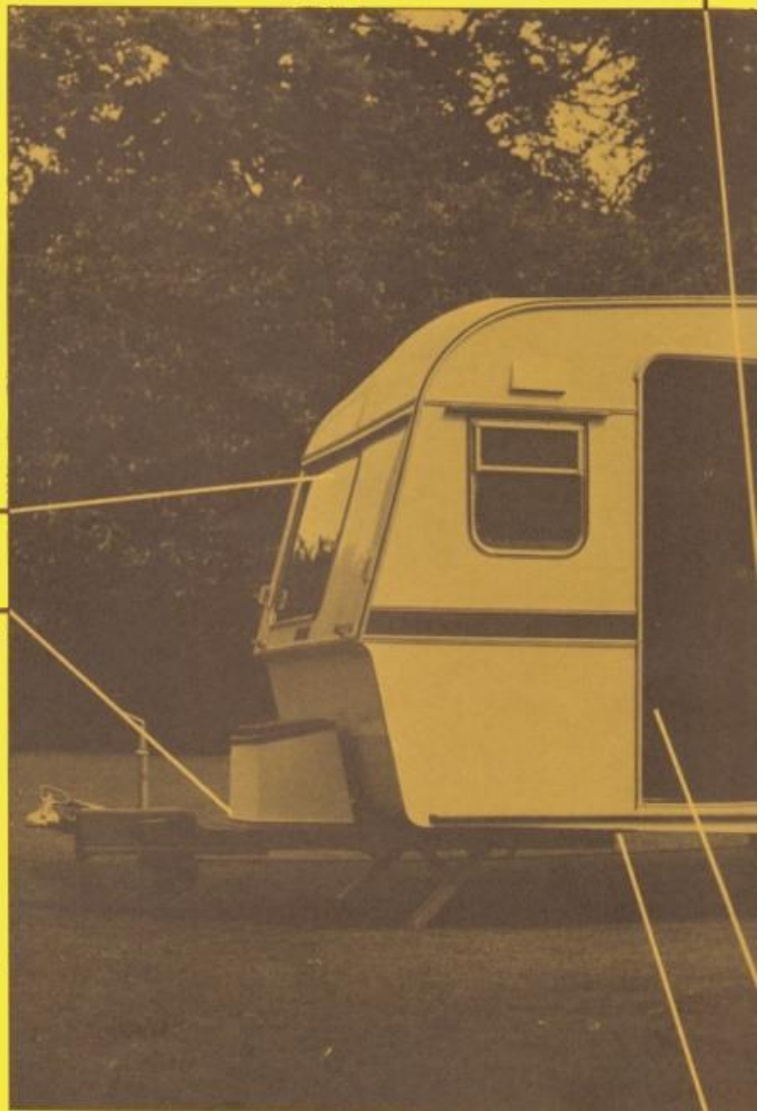

Water inlet, and waste pipe.

It's just like operating a tap at home, except you pump it through with your foot. Pull out the plug and the water runs down into your waste container.





Roof-vent.

We designed our roof-vent to let in air, not rain. Just push up to open, and pull down to close. Open or closed it always lets the light shine through.



Window vents.

When it's not warm enough to be hot, and not cool enough to be cold, flick open the top window for a steady flow of fresh air.



Rear panel.

We've grouped the number plate, back lights and reflectors neatly in a sturdy vacuum formed green plastic panel.



5" mattresses.

Here's one of those 5 inch mattresses we were telling you about. There's nothing more rewarding after a day's touring, or an afternoon walking in the hills.

T-Line Plus Points.

	Mini Glen	Glen 2	Glen 4	Glen 4	Glen 6	Glen 6 1/2	Glen 7	Glen 7 1/2	Glen 8	Glen 8 1/2	Glen 9	Glen 9 1/2
B & B Independent Suspension	✓	✓	✓	✓	✓	✓	✓	✓	✓	✓	✓	✓
Full Frame channel steel chassis	✓	✓	✓	✓	✓	✓	✓	✓	✓	✓	✓	✓
Sigma Automatic 'back-up' coupling	✓	✓	✓	✓	✓	✓	✓	✓	✓	✓	✓	✓
Fully retractable telescopic jockey wheel	✓	✓	✓	✓	✓	✓	✓	✓	✓	✓	✓	✓
Insulated Floor	✓	✓	✓	✓	✓	✓	✓	✓	✓	✓	✓	✓
Gas cylinder chest and carrier	✓	✓	✓	✓	✓	✓	✓	✓	✓	✓	✓	✓
Moulded drawbar fairing	✓	✓	✓	✓	✓	✓	✓	✓	✓	✓	✓	✓
Full road lighting	✓	✓	✓	✓	✓	✓	✓	✓	✓	✓	✓	✓
7-Pin Electrical connector	✓	✓	✓	✓	✓	✓	✓	✓	✓	✓	✓	✓
Full length rubbing strakes	✓	✓	✓	✓	✓	✓	✓	✓	✓	✓	✓	✓
Awning channel	✓	✓	✓	✓	✓	✓	✓	✓	✓	✓	✓	✓
High gloss pre-painted aluminium panelling	✓	✓	✓	✓	✓	✓	✓	✓	✓	✓	✓	✓
Embossed metal stoneguard	✓	✓	✓	✓	✓	✓	✓	✓	✓	✓	✓	✓
Anodised aluminium mouldings	✓	✓	✓	✓	✓	✓	✓	✓	✓	✓	✓	✓
Accommodation for flued heater	✓	✓	✓	✓	✓	✓	✓	✓	✓	✓	✓	✓
Mineral wool insulation - 1" thick	✓	✓	✓	✓	✓	✓	✓	✓	✓	✓	✓	✓
Piano hinges on all furniture	✓	✓	✓	✓	✓	✓	✓	✓	✓	✓	✓	✓
Internal fluorescent lighting	(1) ✓	(1) ✓	(1) ✓	(1) ✓	(1) ✓	(1) ✓	(1) ✓	(1) ✓	(2) ✓	(2) ✓	(2) ✓	(2) ✓
Full gas lighting	(1) ✓	(1) ✓	(2) ✓	(1) ✓	(2) ✓	(2) ✓	(2) ✓	(2) ✓	(1) ✓	(2) ✓	(2) ✓	(2) ✓
Adjustable back rests on single beds	✓	✓	✓	✓	✓	✓	✓	✓	✓	✓	✓	✓
Water inlet and waste pipe nozzles	✓	✓	✓	✓	✓	✓	✓	✓	✓	✓	✓	✓
Stainless steel sink and drainer	✓	✓	✓	✓	✓	✓	✓	✓	✓	✓	✓	✓
Foot pump	✓	✓	✓	✓	✓	✓	✓	✓	✓	✓	✓	✓
Tuckaway water faucet	✓	✓	✓	✓	✓	✓	✓	✓	✓	✓	✓	✓
Integral frame windows with vent panels	✓	✓	✓	✓	✓	✓	✓	✓	✓	✓	✓	✓
Space for optional oven cooker	✓	✓	✓	✓	✓	✓	✓	✓	✓	✓	✓	Fitted
Space for optional 1 cu. ft. refrigerator	✓	✓	✓	✓	✓	✓	✓	✓	✓	✓	✓	✓
Quilted mattresses of 5" deep polyfoam	✓	✓	✓	✓	✓	✓	✓	✓	✓	✓	✓	✓
Deep pile carpet with foam underlay	✓	✓	✓	✓	✓	✓	✓	✓	✓	✓	✓	✓
Bottle stowage, crockery rack and cutlery tray	✓	✓	✓	✓	✓	✓	✓	✓	✓	✓	✓	✓
Washable vinyl-faced roof panels	✓	✓	✓	✓	✓	✓	✓	✓	✓	✓	✓	✓
Full compliance with British Standard 4626 (1970) for touring caravans	✓	✓	✓	✓	✓	✓	✓	✓	✓	✓	✓	✓
Overall (shipping) Length (including drawbar)	12' 5" 3785mm.	14' 4265mm.	16' 3" 4950mm.	14' 4265mm.	16' 3" 4950mm.	16' 3" 4950mm.	17' 3" 5260mm.	17' 3" 5260mm.	17' 3" 5260mm.	19' 5790mm.	19' 5790mm.	20' 9" 6325mm.
Body length	9' 7" 2920mm.	10' 9" 3275mm.	12' 8" 3860mm.	10' 9" 3275mm.	12' 8" 3860mm.	12' 8" 3860mm.	13' 9" 4190mm.	13' 9" 4190mm.	13' 9" 4190mm.	15' 7" 4750mm.	15' 7" 4750mm.	17' 4" 5285mm.
Body width	6' 5" 1956mm.	6' 6" 1981mm.	6' 9" 2057mm.	6' 6" 1981mm.	6' 9" 2057mm.	6' 9" 2057mm.	6' 9" 2057mm.	6' 9" 2057mm.	6' 9" 2057mm.	6' 9" 2057mm.	6' 9" 2057mm.	7' 3" 2210mm.
Body height	7' 7" 2310mm.	7' 8" 2340mm.	7' 10" 2390mm.	7' 8" 2340mm.	7' 10" 2390mm.	7' 10" 2390mm.	7' 11" 2410mm.	7' 11" 2410mm.	7' 11" 2410mm.	8' 1" 2464mm.	8' 1" 2464mm.	8' 1" 2464mm.
Delivered weight (Tolerances 3%)	9 1/4 cwt. 470 kg.	10 1/2 cwt. 530 kg.	12 1/2 cwt. 635 kg.	10 1/4 cwt. 520 kg.	12 1/2 cwt. 635 kg.	12 1/2 cwt. 635 kg.	12 1/2 cwt. 650 kg.	12 1/2 cwt. 650 kg.	13 1/2 cwt. 700 kg.	14 cwt. 750 kg.	14 cwt. 750 kg.	18 cwt. 915 kg.
Maximum authorised gross weight	12 cwt. 610 kg.	13 1/2 cwt. 685 kg.	16 1/2 cwt. 825 kg.	13 1/2 cwt. 685 kg.	16 1/2 cwt. 825 kg.	16 1/2 cwt. 825 kg.	16 1/2 cwt. 850 kg.	16 1/2 cwt. 850 kg.	17 1/2 cwt. 875 kg.	20 cwt. 1030 kg.	20 cwt. 1030 kg.	23 cwt. 1170 kg.
Tyre size	5.20 x 13	5.20 x 13	5.90 x 13	5.20 x 13	5.90 x 13	5.90 x 13	5.90 x 13	5.90 x 13	5.90 x 13	6.40 x 13 (6 ply)	6.40 x 13 (6 ply)	6.40 x 15 (6 ply)
Tow ball height (middle of ball, car laden)	15 1/2" 395mm.	15 1/2" 395mm.	15 1/2" 395mm.	15 1/2" 395mm.	15 1/2" 395mm.	15 1/2" 395mm.	15 1/2" 395mm.	15 1/2" 395mm.	15 1/2" 395mm.	15 1/2" 395mm.	15 1/2" 395mm.	15 1/2" 395mm.

The issue of this brochure does not constitute an offer and sales are conditional upon terms of business and express warranty issued by the makers of the caravans.

While the information contained in this brochure is correct at September 1974 it may be that, on account of the use of alternative materials or the shortage of supplies, alterations may have to be made to the caravans described in this brochure.

Particulars of any changes may be obtained from Thomsons (Carron) Limited.

Thomson T-Line Caravans,
Caravan Manufacturers approved by
National Caravan Council.

LIBRARY

29 NOV 1974

TECHNICAL LIBRARY

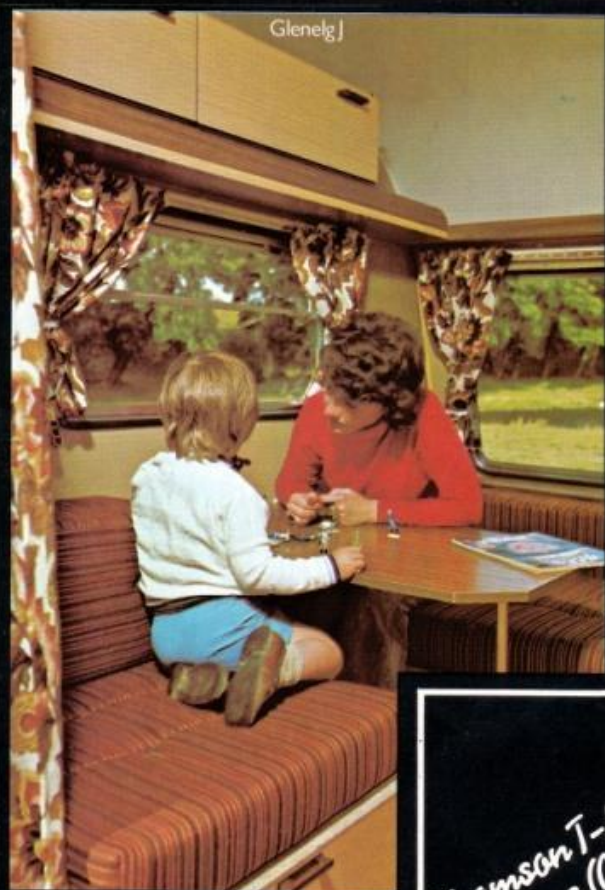

Thomson T-Line Caravans
 Thomsons (Carron) Limited
 Carron, Falkirk, Scotland.
 Phones: Carron (03245) 2202
 Cables: Caravans, Falkirk.



Thomson

See the Thomson models at these
Gailey Sales Centres: —



Bishop Auckland, Bradford, Cardiff, Cranham, Gailey, High Wycombe,
Huddersfield, Leicester, Meriden, Orpington, Portsmouth, Sheffield,
Stockport, Telford, Warley.



Model	No. of Berths	Toilet	Body Length	Body Width	Del. Weight	Laden Weight	Suspension	Interior	Exterior
Mini-Glen	2 1 Double	Yes	9' 7"	6' 5"	9½ cwt	12 cwt	B & B independent automatic reversing, Sigma coupling.	Fitted carpet, stainless steel sink, water pump, strip lighting	Pre-painted aluminium
Glen 4	4 1 Double 1 Single 1 Bunk	No	10' 9"	6' 6"	10½ cwt	13½ cwt	As above	As above	As above
Glen 2	2 2 Singles	Yes	10' 9"	6' 6"	10½ cwt	13½ cwt	As above	As above	As above
Glendale	2 2 Singles	Yes	12' 8"	6' 9"	12½ cwt	16½ cwt	As above	As above	As above
Glennevis	4 (5th opt.) 1 Double 1 Single 1 Bunk	Yes	12' 8"	6' 9"	12½ cwt	16½ cwt	As above	As above	As above
Glennevis J	4 2 Doubles	Yes	12' 8"	6' 9"	12½ cwt	16½ cwt	As above	As above	As above
Glenbervie	4 1 Double 1 Single 1 Bunk	Yes and Vanitory unit and wash basin	13' 9"	6' 9"	13½ cwt	17½ cwt	As above	As above	As above
Glenelg	4 (5th opt.) 1 Double 1 Single 1 Bunk	Yes	13' 9"	6' 9"	12½ cwt	16½ cwt	As above	As above	As above
Glenelg J	4 2 Doubles	Yes	13' 9"	6' 9"	12½ cwt	16½ cwt	As above	As above	As above
Glenalmond	4 (5 & 6 opt.) 2 Singles 1 Double	Yes	15' 7"	6' 9"	14½ cwt	20½ cwt	As above	As above	As above
Glenmore	4 (5th opt.) 1 Double 1 Single 1 Bunk	Yes	15' 7"	6' 9"	14½ cwt	20½ cwt	As above	As above	As above
Gleneagle	4 (5 & 6 opt.) 2 Singles 1 Double	Yes	17' 4"	7' 3"	18 cwt	23 cwt	As above Beta IV coupling	As above	As above

THOMSON

Mini-Glen 2

Glen

Glen 2B

Glendale

Glennevis

Glenelg

Glenbervie

Glenalmond

Glenmore

Gleneagle

L

W

BERTHS DEL WEIGHT

LADEN

12WEIGHT

£734.40

£745.20

£820.80

£912.60

from £896.40

from £955.80

£988.20

£1047.60

£1047.60

£1231.20